

RP RABINE EQUIPMENT (586) 949-3320

Wayne 12volt Burner Assembly

Features:

- 12v solid state constant duty ignitor
- 12VDC, permanent magnet motor
- Flamelock results in improved efficiency and lower emissions
- Low nozzle temperatures
- Controlled flame pattern



- Firing capacity: 0.50 to 2.75 BPH
- Fuel pump: Compact 3450rpm, single stage
- Motor: 12VDC permanent magnet, 4500 rpm
- Ignition: 20,000v/28MA/50VA secondary

| Part | Product |
|------|---------|
| 4137 | MSR-DC |

Wayne EHASR Burner Assembly

- Lower emissions
- Quiet stops and starts
- UL listed

- Firing cap: 0.75 to 3.00 BPH
- Fuel pump: 3450 RPM
- Motor: 3450 rpm
- Ignition: 10,000v/23MA

Fuel nozzle & solenoid sold separately



| Part | Product | Volts | Fan |
|------|---------------|-------|--------|
| 3603 | 239-001 EHASR | 115 | 6-1/4" |
| 3604 | 239-005 EHASR | 230 | 6-1/4" |

Wayne Burner Parts

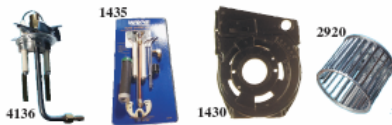

| Part | Product |
|------|---|
| 4136 | Fuel gun assembly (31762-005) |
| 1430 | 3142-001 Wayne E Housing 6.25" |
| 1435 | Burner tune up kit (E&M) (31156) |
| 1429 | Electrodes (2/pack) (13286) |
| 1425 | Blower wheel 3.44" x 5 1/4" Model E |
| 1426 | Blower wheel 6 1/4" x 4" Model E |
| 2920 | Blower wheel 12v 4 1/4" x 3 1/2" 1/2" shaft |
| 5591 | Blower wheel 12v 4.5"x2.44" 5/16" shaft |
| 1431 | Large standard gasket (12484) |
| 1428 | Coupling, Model "E" (13279) |
| 1434 | 6" oil line assembly (14451) |
| 1222 | 8" oil line assembly (14452) |
| 1427 | SER buss bar, G-shape (12945) |

Beckett Burner Parts

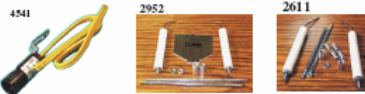

| Part | Product |
|------|--|
| 2952 | Electrode assembly kit (5780) |
| 2611 | Electrode assembly kit (5781) |
| 4541 | Cad cell flame detector (7006U) |
| 2951 | Blower wheel "S" 5 3/4" x 3-7/16" |
| 2949 | Blower wheel "S" 6 1/4" x 3-7/16" |
| 5246 | Blower wheel 12V 4 1/4" x 2-7/16" |
| 2607 | Coupling 7/16" shaft S series (2290) |
| 2606 | Coupling 5/16" shaft A series (2454) |
| 2614 | Gasket, Universal (3616) |
| 2604 | 6.5" connector tube assembly (A, AF) |
| 2605 | 8" connector tube assembly (S, SF, SM) |

Burner Motors

12 volt



3950 RPM
8.5 AMPS

1/6 HP
3450 RPM
12 AMPS

| Part | Product |
|------|----------------------|
| 3065 | 101126-002 Wayne 12v |
| 3767 | 21699UF Beckett 12v |

Capacitor Start Motors

- 3450 RPM
- ccw rotation
- Thermally protected
- M frame 6 3/4" bolt to center
- N frame 7 1/4" bolt to center



| Part | Product |
|------|---------------------------|
| 2946 | 1/7 HP 120v 48M frame |
| 3442 | 1/5 HP 115/230v Universal |
| 4095 | 1/4HP 115v 48N frame |

Non-Capacitor Start

- 3450 RPM
- ccw rotation
- Thermally protected
- M frame 6 3/4" bolt to center
- N frame 7 1/4" bolt to center



| Part | Product |
|------|-----------------------|
| 2947 | 1/7 HP 220v 48M frame |
| 1214 | 1/5 HP 115v 48N frame |
| 1432 | 1/4HP 220v 48N frame |



Reliable transformer testing! Lightweight, compact, instant results!

A fast, portable, dependable way to instantly test transformers and electronic ignitors!
Easy to use and makes service calls a breeze. Simply touch the high voltage spheres to the high contacts of any brand transformer or ignitor and the green LED lights up if the unit is good.



| Part | Product |
|------|-----------|
| 6748 | Chek-Mate |

Electronic Ignitors

Receives 120 vac and changes it to DC voltage inside. DC voltage turns power transistors on and off very quickly, conducting current through the primary coil at frequency of 15,000 to 30,000 Hz. The secondary coil produces a high voltage ignitor output frequency of 15,000 to 30,000 Hz.

- 1/4 to 1/2 the size and weigh less than transformer
- Offer improved performance with cold or delayed spark conditions
- Output currents and peak voltages up to double of iron core transformer Spark intensity less sensitive to line voltage fluctuations
- Consume 50 to 75% less power than transformers

Omni Ignitor™

Have the proper ignitor in stock at all times!

The omni ignitor will replace most ignitors on the market today. By using the Omni with it's universal mounting plate, remove the defective ignitor and attach to the ignitor's plate.



Omni mounts to mounting bases manufactured by Beckett, Wayne, Carlin, France.

Makes service calls and stocking requirements simple and less costly.

| Part | Product |
|------|-----------------------------------|
| 6745 | 12vdc Omni Ignitor |
| 6746 | 120v Omni Ignitor |
| 6747 | 240v Omni Ignitor |
| 6759 | 2604 Base Plate Beckett "A", "AF" |
| 6758 | 2601 Base Plate Beckett "S" |
| 6760 | 2603 Base Plate Wayne "E" |
| 6761 | 2602 Base Plate Wayne "M" & "MH" |

Beckett Ignitors

End mount Ignitors

Base length of A, AF ignitors 5 3/4"
Base length of S ignitors 7 1/2"

12 Volt Custom Coil

With control board and electric eye
12VDC, 4.8 amps



| Part | Model |
|------|----------------|
| 6194 | Beckett 51776U |



| Part | Burner Model |
|------|-----------------------------|
| 5947 | Beckett 7435U Ignitor only |
| 3768 | Beckett 51777U A, AF w/base |
| 3862 | Beckett 51779U S w/base |

120 Volt



| Part | Bumer Model |
|------|-----------------------------|
| 5054 | Beckett 51838U ignitor only |
| 4887 | Beckett 51771U A, AF w/base |
| 4538 | Beckett 51824U S w/base |
| 4471 | Terminal kit |

Wayne Electronic Ignitors

12 Volt Custom Coil



| Part | Burner Model |
|------|-----------------------------|
| 5947 | Custom Coil Ignitor only |
| 5948 | E burner w/base side mount |
| 5951 | "M" burner w/base end mount |

RP RABINE EQUIPMENT (586) 949-3320

120 Volt



| Part | Burner Model |
|------|----------------------------|
| 5054 | 10 Say-04 ignitor only |
| 4545 | 10 Say-30 Wayne "E" w/base |
| 5111 | 10 Say-03 Wayne "M" w/base |
| 4471 | Terminal kit |

Transformers

Known as "iron core" transformer, it draws 120 vac into the primary coil. The steel plates of the transformer core transfer the primary coil's 60Hz magnetic field to the secondary coil.

The secondary coil uses this field to produce a high output voltage of 10,000 VRMS open circuit (when there is no secondary current flowing) that has a frequency of 60Hz.

Allanson Transformers
ENVIRONMENTAL ELECTRICS



| Part | Burner Model |
|------|---------------------|
| 6258 | 120v Beckett A, AF |
| 6204 | 120v Beckett "S" |
| 6229 | 240v Beckett A, AF |
| 6222 | 240v Beckett "S" |
| 6205 | 120v Wayne M&HS end |
| 6206 | 120v Wayne "E" side |
| 6211 | 240v Wayne "E" side |

France Transformers



| Part | Bumer Model |
|------|-------------------------------|
| 1309 | 120v Wayne "E" side (5LAY-30) |
| 1310 | 240v Wayne "E" side (5LDY-30) |

Clean Cut Fuel Pumps

PRODUCT FEATURES:

- Reduces truck inventory
- Built-in solenoid valve, bypasses flow of oil instantly when power is cut, resulting in cleaner shutdowns
- Reduced motor load, Clean cut allows oil to freely bypass the piston, reducing the demands on the motor during startup.
- Higher capacity, unique design delivers up to 4 gallons per hour at 150 PSI

| Part | Model |
|------|-------------------|
| 6588 | 12 volt |
| 6591 | 120 volt |
| 6564 | 240 volt |
| 6589 | 12v coil (Green) |
| 6566 | 120v coil (Black) |
| 6594 | 240v coil (White) |



PD Timer (option)

Adds a brief, highly consistent "valse-on" delay to establish airflow and brings the pump up to speed for smoother light-offs. May be useful on some auto start pressure washers

| Part |
|------|
| 6582 |



Fuel Pumps

3 GPH

| Part | Model | RPM |
|------|-----------|------|
| 1437 | A2VA-7116 | 3450 |
| 1741 | A2VC-7118 | 3450 |
| 5797 | A2VD-7119 | 3450 |



7 GPH

| Part | Model | RPM |
|------|-----------|------|
| 1742 | A1YA-7912 | 1725 |
| 1439 | A2YA-7916 | 3450 |



Waste Oil Heater Pump

| Part | Model |
|------|-----------|
| 6778 | A2RA-7710 |



A2VA-3006 w/Built-in Solenoid

| Part | Solenoid |
|------|-------------|
| 6275 | 12vdc/24vac |
| 6207 | 115volt |
| 6326 | 220volt |



Fuel Pumps

Suntec Solenoid Valves



| Part | Model |
|------|---------------|
| 2203 | 12/24v R261NL |
| 1215 | 115v R642NL |
| 2202 | 220v R753NL |

Solenoid Replacement Parts



| Part | Model |
|------|---------------------|
| 1523 | 3713823 12/24v coil |
| 1524 | 3713824 115v coil |
| 1525 | 3713825 220v coil |
| 1526 | 3753895 pigtail |



Fuel/Water Separator



Multi-stage protection water separator and fuel filtration in a compact size. Fuel flow is controlled so large contaminants are separated and fall into the collection bowl. Aqua bloc elements stop emulsified water and tiny particles of rust, dirt, & algae.

- 15 GPH maximum flow
- Filters gasoline and diesel fuel
- Dual 1/4" fpt ports



| Part | Product |
|------|----------------------|
| 1483 | Fuel filter assembly |
| 1484 | Element w/gasket |
| 3133 | Vent plug RK20179 |
| 3135 | Clear bowl RK10166 |

Fuel/Water Separator



6452

Controls fuel flow and separates water and other elements. Replaceable paper filter element is easy to see through clear plastic bowl.

- 1/4" FPT I/O
- Maximum temp 50°C/122°F
- Filters diesel and gasoline
- 15 GPH maximum flow

6134



| Part | Product |
|------|------------------------|
| 6452 | Small Fuel Assembly |
| 6434 | Medium Filter assembly |
| 6134 | Large assembly w/drain |
| 6453 | Small cartridge |
| 6436 | Medium cartridge |
| 6144 | Large cartridge |

KO Koll Kleen

Granular powder that works to dissolve lime and scale buildup on coils. Used as directed, it is safe for personnel and equipment. Contains a built-in inhibitor that offers protection to most metal surfaces.



Biodegradable
Safe on equipment
Easy to use

Case lots only, drop ship from vendor.

| Part | Product |
|------|--------------|
| 4791 | Case (4-8lb) |

Red Devil Soot Remover

Formulated to attack existing soot formations and prevent further buildup.



- Keeps heating system cleaner
- Combats formation of sludge and gum
- Emulsifies and removes water from fuel tank
- Harmless to metal

1 oz. to 10 gallons for treatment

| Part | Product |
|------|----------------|
| 2619 | Case 12 pints |
| 2618 | Pint Red Devil |

Mitco Can Type Filters



- With micro-flow filter element
- Galvanized can for rust protection
- High capacity containment reservoir extends filter life
- Highest UL pressure rating
- Highest UL GPH rating
- 360° screw driver slot for fast removal
- 10 GPH flow rate

| Part | Product |
|------|-------------------|
| 3069 | 264 Fuel assembly |

Mitco Micro Oil Filter



3071

- Designed for full range of nozzle gallonage
- Extremely efficient in filtering particles
- Largest volume of filter material
- Increased holding capacity
- Non-shed design is fiber welded
- No bonding agents to clog filter

| Part | Product |
|------|----------------------|
| 3071 | 264-48 micro element |

Felt Fuel Oil Element

3070



- Prevent clogged burner nozzles and reduce service problems
- High grade wool material
- Gasket included

| Part | Product |
|------|---------------------|
| 3070 | 264-1A felt element |

RP RABINE EQUIPMENT (586) 949-3320

Hago Fuel Nozzles

100% tested on oil for accuracy of flow rate, spray angle, concentricity, and spray quality.

Unique ribbed sintered bronze filter
 Special high chrome, heat resistant stainless steel
 Bronze sintered filters rated for filtration to 40 microns
 Fits all popular oil burners
 Thread size: 9/16" x 24



A/H Hollow Cone Red Caps:
 Distributes atomized oil particles evenly toward the outside of the spray cone. Particularly well suited for low firing rates and burners with a hollow air pattern. Normally used in wider spray angles.

B Solid Cone Black Caps:
 Designed to give optimum combustion efficiency on high static pressure flame retention burners which specify a "B" pattern. Fuel is concentrated toward the center of the flame.

P Solid Cone Green Caps: Extension of the "B" series for firing rates of 2.00 GPH and above. Produces a solid cone pattern in the low rates and becomes more hollow as the flow rate increases. Specially designed with a pocketed disc to reduce combustion noises and pulsation

| Spray angle | Flow Rate Range | Spray angle | Flow Rate Range | Spray angle | Flow Rate Range |
|-------------|-----------------|-------------|-----------------|-------------|-----------------|
| 60° | .40-9.00GPH | 60° | .50-2.00GPH | 60° | 2.00-35.00GPH |
| 70° | .40-9.00GPH | 70° | .50-2.00GPH | 70° | 2.00-35.00GPH |
| 80° | .40-9.00GPH | 80° | .50-2.00GPH | 80° | 2.00-35.00GPH |
| 90° | .50-9.00GPH | 90° | .50-2.00GPH | 90° | 2.00-35.00GPH |

| | NOZZLE SIZE | | | NOZZLE SIZE | | | NOZZLE SIZE | | | | | |
|---------------------------------|-------------|------|------|-------------|------|------|-------------|------|------|-------|------|------|
| | 60A/H | 60B | 60P | 70A/H | 70B | 70P | 80A/H | 80B | 80P | 90A/H | 90B | |
| G A L L O N S | 1.00 | 1314 | 1321 | 1328 | | | 1343 | 1354 | | 1370 | | |
| | 1.10 | | | | | | 3079 | 1355 | | | 1382 | |
| | 1.20 | 1315 | 1322 | | | | | 1356 | | | | |
| | 1.25 | | 1323 | | | 1331 | 1344 | 1357 | | 1371 | 2384 | |
| | 1.35 | 1316 | 1324 | | | | 1345 | 1358 | | 1372 | 1384 | |
| P E R | 1.50 | 1317 | 1325 | 1329 | | | 1346 | 1359 | | 1373 | 1385 | |
| | 1.65 | | | | | | 1347 | 1360 | | 1374 | | |
| | 1.75 | 1318 | 1326 | 1330 | 1334 | | 1348 | 1361 | | 1375 | 1386 | |
| | 2.00 | 1729 | | | 1335 | | 1349 | 1362 | | 1376 | 1387 | |
| | 2.25 | | | 1327 | | | 1336 | 1350 | | 1363 | 1377 | 1383 |
| H O U R | 2.50 | | | | | | 1337 | 1351 | | 1364 | 1378 | 1388 |
| | 2.75 | | | | | | 1338 | 1352 | | 1365 | 1380 | 1389 |
| | 3.00 | | | | | 1339 | 1353 | | 1366 | 1379 | 1390 | |
| | 3.25 | 1319 | | | | 1340 | | | 1367 | | 1391 | |
| | 3.50 | | | | | | | | 1368 | | 1392 | |
| 4.00 | 1320 | | | | | | | 1369 | 1381 | | | |

Fuel Nozzles

Hago Ecovalve

An economical and ecological solution to the problem of nozzle "after drip." The Eco-valve has been designed inside a nozzle strainer of standard size. It provides a sharp cutoff of flow without creating any measurable pressure drop. No changes to pump pressure. Will not disrupt flow rate, spray angle, or spray pattern of nozzle.



- Up to 5 GPH
- Opens at 115 PSI
- Closes at 70 PSI
- 120 mesh strainer

| Part | Product |
|------|----------|
| 3821 | Ecovalve |

Fuel Nozzle Adapter

| Part | Size |
|------|-----------------------|
| 3720 | 9/16-24NEF x 1/8" FPT |
| 3785 | 9/16-24NEF x 1/4" FPT |



Coll Blanket Insulation

- K-lite ceramic fiber blanket
- 200° F. maximum
- Shipping Dimensions: 25"x19"x19"

| Part | Product | Shipping Wt. |
|------|-----------------------|--------------|
| 3093 | 4 lb. roll 1"x24"x25" | 27 lbs. |
| 4417 | 8 lb. roll 1"x24"x25" | 36 lbs. |